



## MAKING IT HAPPEN *how you can help!*

No one said it's easy to coordinate transportation services. Here are specific things you can do, as a leader in your community or as policy maker, to help communities provide more mobility, more efficiently!

### Revise Policies

#### 1. Hold Harmless

Allow communities to demonstrate the potential of coordinated transportation without being penalized by federal, state, or local rules or regulations.

#### 2. Change Medicare

Change federal regulations to allow non-emergent Medicare transportation to be purchased through brokerages, instead of paying the high costs of unneeded ambulance services.

### Flexible Funding

#### 3. Appropriate Funds

Appropriate federal, state, and local dollars for:

- Local planning for coordination
- Demonstration projects
- Mobility coordinators
- The Washington-Oregon Trip Planner
- Integration of 511 and 211 information lines

#### 4. Provide Flexibility

Allow for co-mingling of federal, state, and local special needs transportation dollars so that local communities can determine how to best provide mobility within their community.

#### 5. Reinvest

Allow cost efficiencies from coordination to be reinvested in more mobility. Examine the limitations imposed by fee for service, or per trip reimbursement of transportation costs, and develop a mechanism to allow block grant-type payments for transportation services that can support mobility regardless of program eligibility.

Examine the feasibility of applying capitation payment models to

transportation funding, allowing providers to expand mobility within set rates.

#### 6. Provide Safety Net

Provide financial safety nets for communities to try out coordinated transportation delivery services without negatively impacting budgets.

### Share Governance

#### 7. Lead and Collaborate

Direct your staff to actively work in partnership with the federal Interagency Transportation Coordinating Council and the Washington State Agency Council on Coordinated Transportation to aggressively pursue coordinated transportation.

#### 8. Coordinate Growth

Integrate transportation, land use, and human services planning at the state and local levels.

### Measure Performance

#### 9. Measure System as a Whole

Assess federal, state, and local performance by looking at the "system" of transportation access, instead of solely at individual transportation programs.

#### 10. Consistent Performance Standards

Develop federal, state, and local standard performance definitions for coordinated transportation. Provide funding for tracking and reporting performance.

#### 11. Report It Once

Streamline federal, state and local reporting requirements for all transportation funding streams.

## MORE MOBILITY, MORE EFFICIENTLY *making it reality in the puget sound region*



## UNITED WE RIDE PUGET SOUND

Leadership Forum on  
Coordinated Special Needs Transportation  
June 14, 2004



# WORKING TOWARD A VISION

*a work in progress*

Representatives of the Coordinated Transportation Coalitions in Pierce, Snohomish, and King Counties have begun working on a regional vision. While the group is still working to refine the concept and get feedback from potential stakeholders, the general working vision and goals for the region are to achieve:

- Seamless access to transportation services in Puget Sound
- 1. **Simplify** how individuals, businesses and agencies plan, book, and pay for affordable, flexible, quality transportation delivery in the Puget Sound region.
- 2. **Increase efficiencies and effectiveness** of transportation services in the Puget Sound region by coordinating resources, sharing information, and reducing duplicative services to make funds available for more mobility.

## 4 WAYS TO GET A TRIP

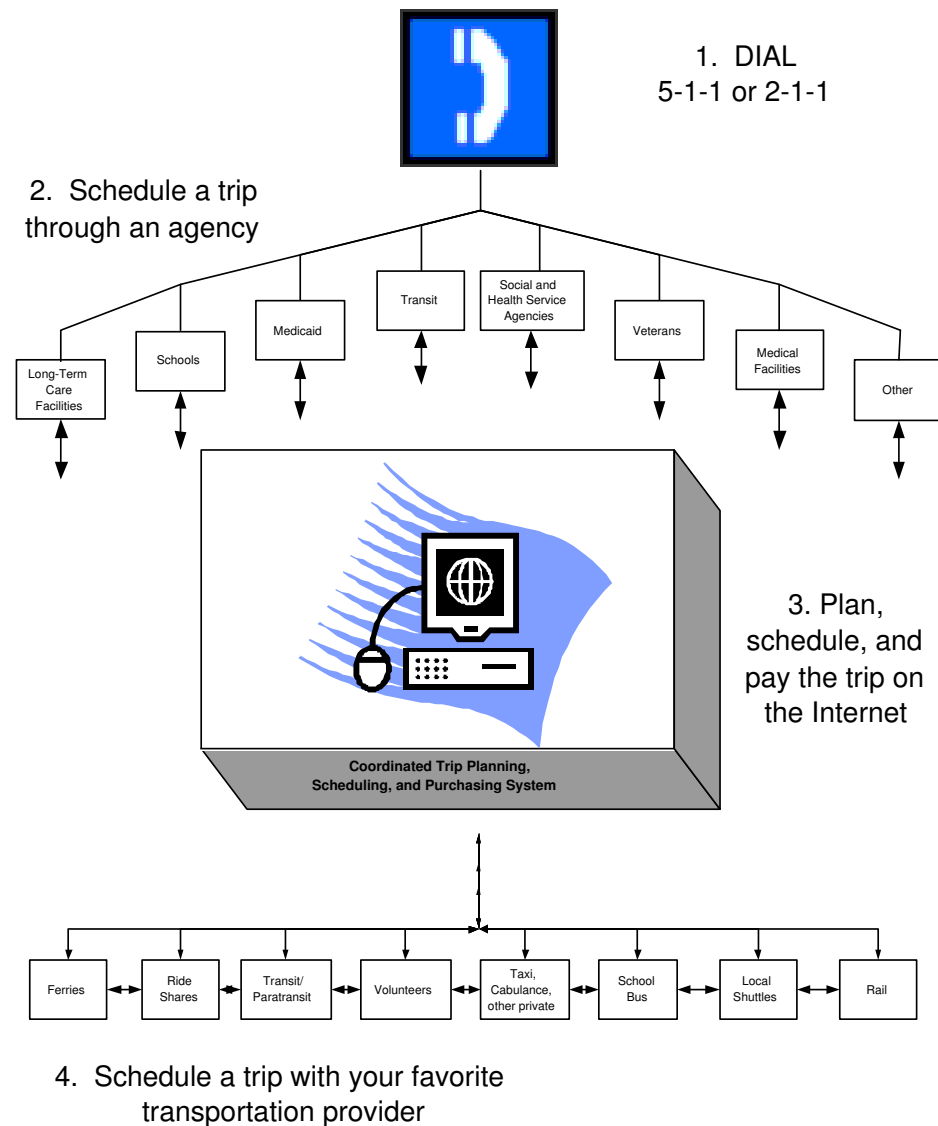

# DEMONSTRATING THE POSSIBILITIES

*four projects to support*

The Agency Council on Coordinated Transportation and the local coordinated transportation coalitions in Pierce, Snohomish, and King Counties are actively seeking funding to implement projects that pave the way for enhanced transportation coordination between transit, social service, and student transportation. Four are highlighted here.

### FindaRide.Org

*King, Pierce and Snohomish Counties*

Sound Transit and King County Metro are currently building an on-line transportation directory called FindaRide.org. This site will provide information on private and public transportation options in King County, in particular those that serve people with special transportation needs. In addition, this database will provide the data to the Washington-Oregon Trip Planner.

#### Project Description

Expand FindaRide.org to include Pierce and Snohomish transportation providers and provide the site with added functionality.

#### Estimated Cost Range

\$150,000 - \$200,000

#### Contact

Michael Miller  
Sound Transit  
(206) 689-4927

### Shared Trip Information

*Pierce County*

The Pierce County Coordinated Transportation Coalition (PCCTC) is working to implement a demonstration project between Pierce Transit and the Medicaid transportation brokerage, which would group specific ADA and Medicaid trips when appropriate. With current systems, the coordinated trip scheduling would have to be done manually.

#### Project Description

Utilize technology to integrate trip reservation data, schedule coordinated trips, and allocate trip costs between Pierce Transit and the Medicaid transportation brokerage. *Estimated Cost: \$200,000*

#### Estimated Cost Range

\$180,000 - \$240,000

#### Contact

Jackie Montgomery  
Pierce County Community Services  
(253) 798-2831

### Homeless Students

*King, Pierce, Snohomish School Districts*

The McKinney-Vento Homeless Assistance Act requires school districts to provide or arrange for the transportation of homeless children and youth to and from the homeless child's or youth's school of origin. This unfunded expense of transporting students across jurisdictional lines has a significant financial burden on local school districts.

#### Project Description

Provide matching funds to school districts that work with local coalitions to coordinate homeless transportation and lower the overall costs of providing the trips.

#### Estimated Cost Range

\$250,000 - \$350,000

#### Contact

Jacque Mann-Israel  
Puget Sound Educational Service District  
(253) 596-6906

### Shared Passenger Profiles

*Snohomish County*

In their 5-year Strategic Plan, the Snohomish County Coordinated Special Transportation Needs Coalition (SNOTRAC) identified a problem. To be eligible for trips for different programs, people with special transportation needs are filling out multiple forms.

#### Project Description

Develop a common eligibility intake form for the two transit agencies, senior services, and the Medicaid trips. Passenger will only have to complete 1 form to be eligible for multiple programs.

#### Estimated Cost Range

\$45,000 - \$60,000

#### Contact

Coey Gilleland  
Senior Services of Snohomish County  
(425) 290-1265